

Rated Voltage (Vac)	220
Rated Power (w)	1300
Rated Torque (N.m)	8.34
Peak Torque (N.m)	25.02
Rated Speed (rpm)	1500
Peak Speed (rpm)	4500
Rated Current (Amp)	9.3
Peak Current (Amp)	27.9
Torque Const (N.m/Amp)	0.86
Back EMF Const(V/Krpm)	52.4
Resistance(Ω)	$0.58 \pm 10\%$
Inductance(mH)	$5.8 \pm 20\%$
Inertia ($\text{kg} \cdot \text{m}^2 \cdot 10^{-4}$)	18.7
Poles	10
Encoder type	23bit optical
IP rating	IP67
Mass (Kg)	7.0
Allowable radial load(N)	686
Allowable thrust load(N)	343

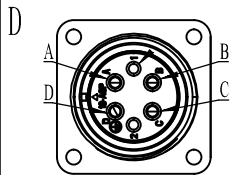

Assignment of power connector				
Pos	A	B	C	D
Signal	U	V	W	PE
Color	Blue	Black	Red	Yellow/green

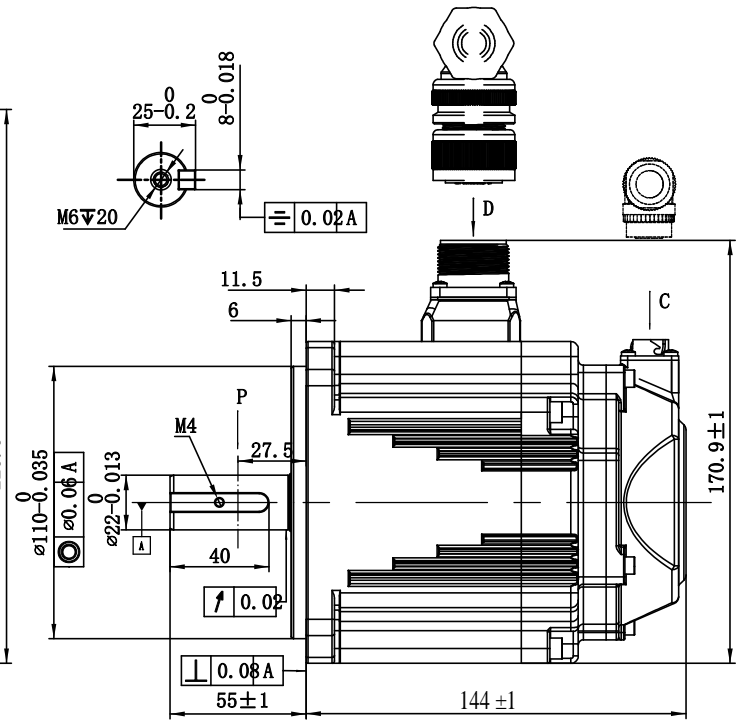
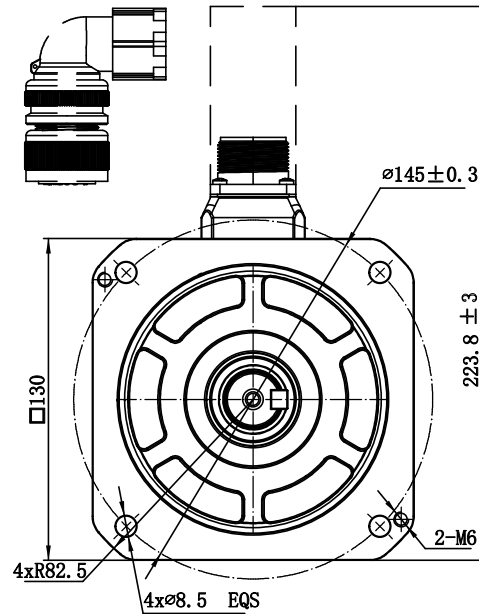
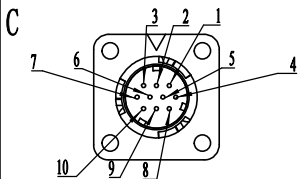

Assignment of encoder connector							
Pos	2	3	4	5	6	7	10
Signal	5V	0V	SD+	SD-	BAT+	BAT-	PE

The curve of torque-speed

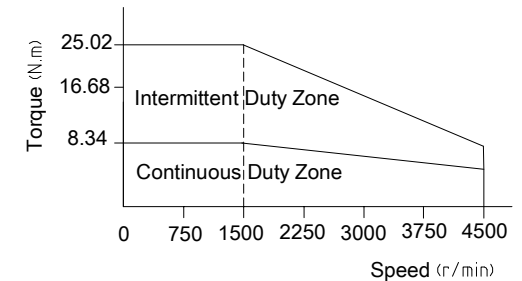

Leadshine Technology Co .Ltd

ELM2H-1300LD130F-H

130mm , high inertia ,1300w servo motor
23bit optical encoder, no brake